

NOTES:

1. 1,000 lbs. WORKING LOAD.
2. ONE PIECE FULLY EMBEDDED 200 SERIES DAVIT BASE (BENT PLATE) ASSEMBLY SHOWN AS CAST INTO CONCRETE SLAB.
3. ASSEMBLY SHOWN IS STANDARD 15", 18" & 24" HIGH MODELS FOR MINIMUM SLAB THICKNESS OF 8".

IMPORTANT:

1. DAVIT BASES ARE DESIGNED TO A TYPICAL SUSPENSION LOAD OF 1,000 lbs. (4.5 KN), WITH A FACTOR OF SAFETY OF 4 AGAINST FRACTURE OR DETACHMENT.
2. IT IS THE RESPONSIBILITY OF THE STRUCTURAL ENGINEER FOR THE OVERALL PROJECT TO ENSURE THAT THE STRUCTURE ON WHICH THE SAFETY EQUIPMENT BY PRO-BEL IS INSTALLED, IS REINFORCED TO WITHSTAND THE LOADS INDICATED ON THIS DRAWING.

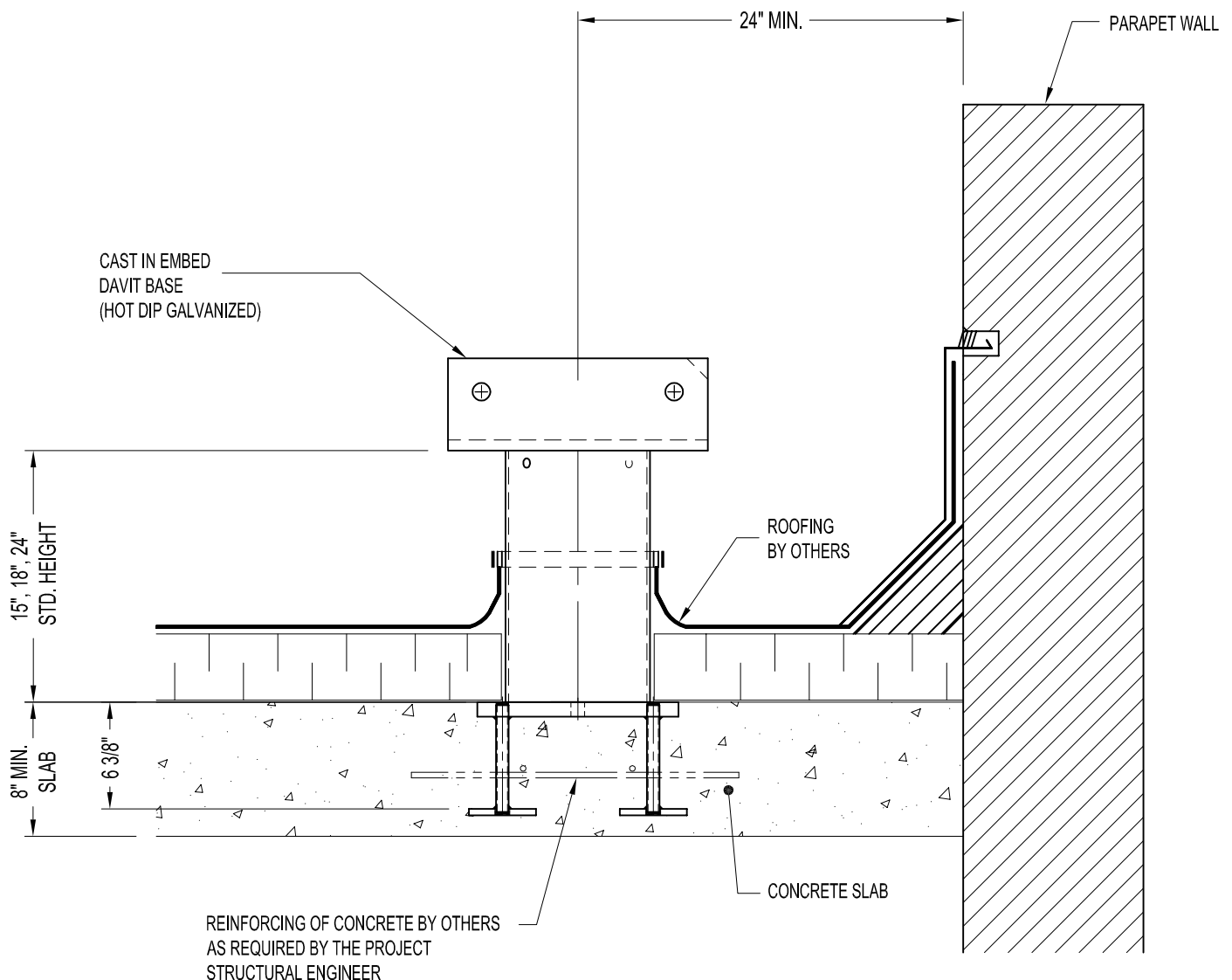

DB2-23108: 200 SERIES DAVIT BASE ASSEMBLY (ONE PIECE CAST IN EMBED) - w/ NO U-BAR